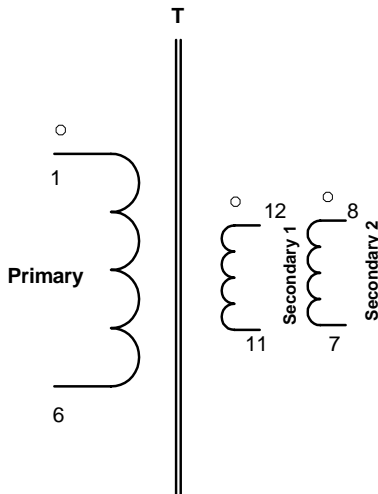

Table 1: Electrical Specifications at 25 °C.

PARAMETER	SPECIFICATION LIMITS			UNITS
	MIN	TYP	MAX.	
Primary Inductance (1—6) 1Vrms @ 100 KHz	10.20	12.00	—	mH
Turns Ratio's: SEC : PRI	—	1:3	—	± 4%
Primary Leakage Inductance 1Vrms @ 100 KHz	—	—	50	μH
Design Parameters: Switching Frequency	-----	150	-----	KHz
Maximum Duty Cycle	-----	40	45	%
Sec Output Voltage	38	40	42	V
DCR (MAX) Primary (1-6)	-----	-----	200	mOhm
Secondary 1 (7-8)	-----	-----	50	
Secondary 2 (11-12)	-----	-----	50	

Figure 1: Schematic Diagram



Note:

1. All materials meet UL94V-0 and are non-flammable.
2. All materials rated 130° C.
3. Dimensions in mm, .XX±0.8.
4. All hipot voltage are AC VOLTS RMS specified below at 60 Hz for one minute. The leakage current doesn't exceed 25 μA rms.
 A/. 1500V mini from (1&6) with respect to (7&8) and (11&12).
 B/. 500V mini from (7&8) with respect to (11&12).
 C/. 1500V mini from any pin of coil to core.

Figure 2: Component Side View

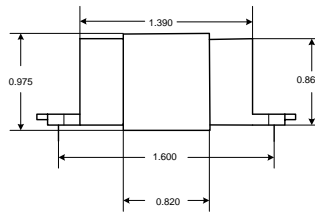

Figure 3: Physical Dimensions in mm.

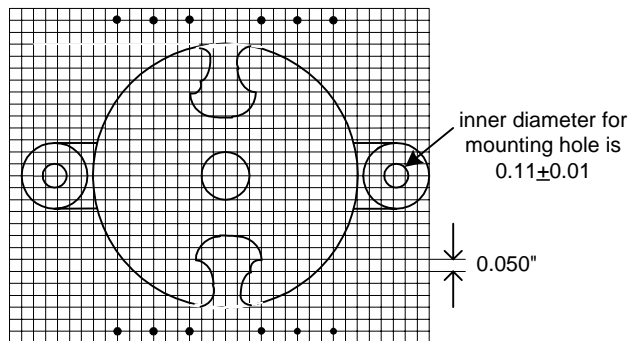

Figure 4: Transformer foot print.

